

MRT FENCING

AGRICULTURAL
PRODUCTS



MRT

MRT IN ESSENCE

Moreda Riviere Trefilerías (MRT) is the leading fencing manufacturer in Spain and one of the main references in Europe. Accordingly, MRT offers a wide range for residential, professional, industrial and agricultural sectors. MRT is part of the Celsa group, the company leader in Europe for the production of circular steel with low CO₂ emissions.

MRT figures



**LEADER
IN SPAIN**



2 FACTORIES
265,000 m²



**400+
EMPLOYEES**



**150+ YEARS
OF EXPERIENCE**



**60+
COUNTRIES**

MRT holds ISO 14001:2015 certification for the manufacturing of low-carbon steel fencing and wire drawing, under an environmental management system (SGM).



Safety a priority

MRT constantly strives to ensure an injury and illness-free work environment for everyone who participates in its activities. The Occupational Health and Safety Management System (SG-SST) has a whole series of programs implemented far beyond the legal requirements, emphasising the priority given to this key objective. The efforts led to the awarding of ISO 45001:2018 certification.

Our values

Honesty - Humility - Creative perseverance
Groundbreaking approach - Teamwork - Passion

MRT in the United Kingdom

MRT has demonstrated its desire to invest in progress by commissioning the UK Distribution Centre in the Midlands. The ability to provide smaller loads of the fastest moving stock fence, security, mesh panel, rolled mesh and chain link products to meet urgent requirements is complimented by the cost efficiencies of delivering imported full loads across the Dealer Network.

MRT FENCING

- 1 30+ years supporting British and Irish farming
- 2 Recognised company for its product quality
- 3 A big warehouse in UK



STRENGTH OF CELSA



**5+ MILLION
TONNES OF
STEEL PRODUCED
ANNUALLY**



**7+ MILLION
TONNES OF
SCRUB RECYCLED
ANNUALLY**



**10,000+ EMPLOYED
(DIRECT AND
SUBCONTRACTED
PROFESSIONALS)**



**6,000+
MILLION EUROS
OF ANNUAL
TURNOVER**

Celsa produces steel in electric arc furnaces, using the most sustainable and energy-efficient technology from recycled ferrous scrap. By opting, since beginning, to manufacture steel from the recycling of ferrous materials, Celsa has a production model that is part of a sustainable development approach, thus leading the circular transformation. Nowadays, it is already defined as “Low Carbon” company.

Furthermore, far from settling for this, Celsa has set the following main objectives: By 2030, reduce CO₂ emissions (scope 1 and 2) by 50% and achieve 98% circularity. By 2050, be a “Net Positive” company.

VERTICAL INTEGRATION AND CIRCULARITY

The group is increasingly vertically integrated, both upstream and downstream. This integration throughout the steel production chain allows for synergies to be achieved more efficiently; both environmentally and energy-wise, with the facilities to implement continuous improvement with excellent traceability throughout.

From the purchase of raw materials throughout the transformation into finished products, through the wire rod drawing process, wire galvanizing, welding and wire braiding, everything is done within Celsa and MRT.

CELSEA

Transforming today.
Strengthening tomorrow.

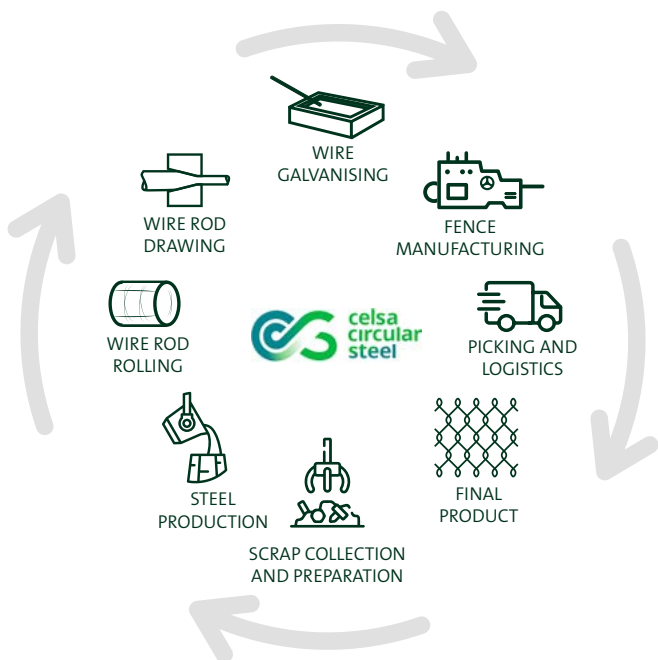

INDEX

1. STOCK FENCING

Manufactured according to BS EN10223-5, produced according to BS 4102, fully galvanised to BS EN10244-2.

Masterfence® Light	6
Masterfence® Medium	10
Masterfence® Heavy	12
Masterfence® Light High Tensile	13
Masterfence® High Tensile	14
FK MRT®	18
XK MRT®	20

2. BARBED WIRE

Erizo® High tensile	24
Bravo® Mild steel	25
MRT Barbless Wire	26

3. FENCE STAPLES

Fence staples	27
---------------------	----

4. WIRE

Wire	28
Special Coatings	30

5. WIRE NETTING

Wire Netting	31
--------------------	----

6. CHAIN LINK

Chain link	32
------------------	----

7. WELDED MESH IN ROLLS

Welded mesh in rolls	34
----------------------------	----

Moreda Riviere Trefilerías S.A. reserves the right to modify the technical and commercial specifications without notice. In the same way, information and photographs published are checked on a regular basis, but are present for information only and not contractual.



LIGHT STOCK FENCING

MASTERFENCE® Light stock fencing is recommended for lighter stock including sheep. Will remain straight and flat even with impact.



Hinge joint

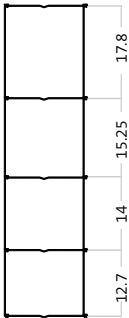

L 5/60/15

Coating
Heavy galvanised



Length
50 m
Vertical spacing
15 cm

Height
60 cm

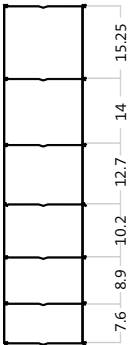

L 7/65/15

Coating
Heavy galvanised

Length
50 m
Vertical spacing
15 cm

Height
65 cm

HORIZONTAL WIRE			VERTICAL WIRE	
TOP AND BOTOM DIAMETER (mm)	INTERMEDIATE DIAMETER (mm)	TENSILE STRENGTH (kg/mm ²)	DIAMETER (mm)	TENSILE STRENGTH (Kg/mm ²)
2.45	1.90	≥71	1.90	45 - 55

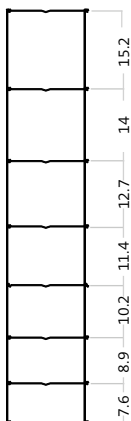
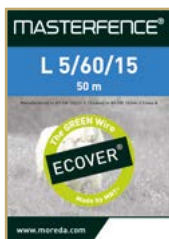
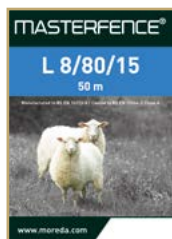

L 8/80/15

Coating
Heavy galvanised

Length
50/100 m

Vertical spacing
15 cm

Height
80 cm

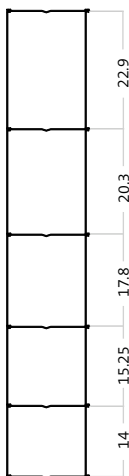

L 6/90/15

Coating
Heavy galvanised

Length
50 m

Vertical spacing
15 cm

Height
90 cm

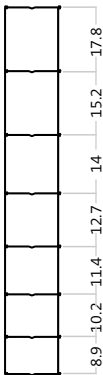
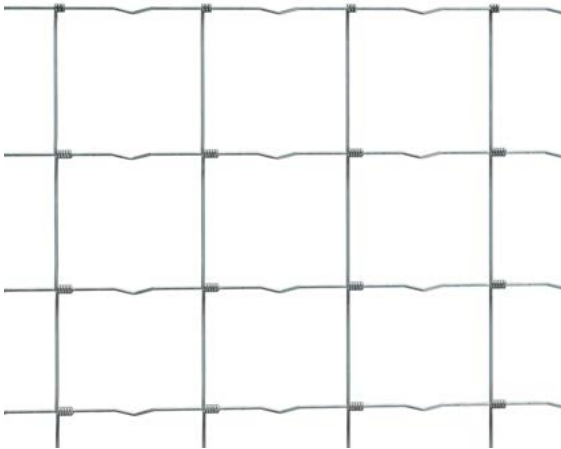

Coating
Heavy galvanised

Length
50 m

Vertical spacing
15 cm

Height
90 cm

L 8/90/15

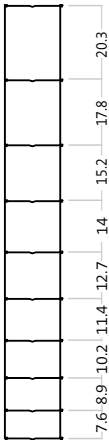

Coating
Heavy galvanised

Length
50 m

Vertical spacing
15 cm

Height
120 cm

L 10/120/15

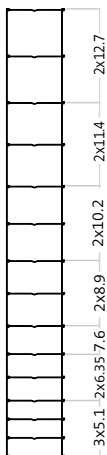

L 15/120/15

Coating
Heavy galvanised

Length
50 m

Vertical spacing
15 cm

Height
120 cm

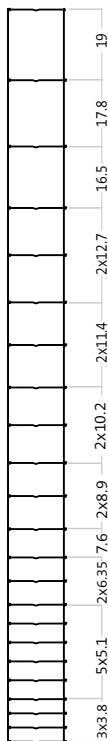

L 23/200/15

Coating
Heavy galvanised

Length
50/100 m

Vertical spacing
15 cm

Height
200 cm



MEDIUM STOCK FENCING

MASTERFENCE® Medium stock fencing is recommended for pig, cattle and horse enclosures.



Hinge joint

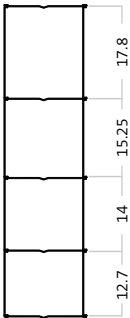

C 5/60/15

Coating
Heavy galvanised

Length
50 m

Vertical spacing
15 cm

Height
60 cm

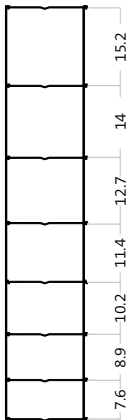

C 8/80/15

Coating
Heavy galvanised



2



Length
50/100/300 m

Vertical spacing
15 cm

Height
80 cm

HORIZONTAL WIRE			VERTICAL WIRE	
TOP AND BOTOM DIAMETER (mm)	INTERMEDIATE DIAMETER (mm)	TENSILE STRENGTH (kg/mm ²)	DIAMETER (mm)	TENSILE STRENGTH (Kg/mm ²)
3.00	2.45	≥71	2.45	45 - 55

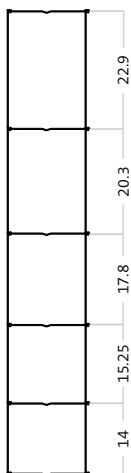
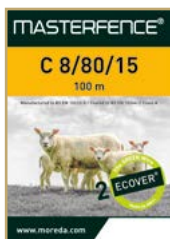
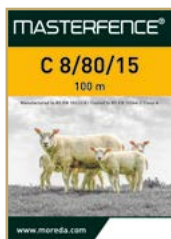

Coating
Heavy galvanised

Length
50 m

Vertical spacing
15 cm

Height
90 cm

C 6/90/15

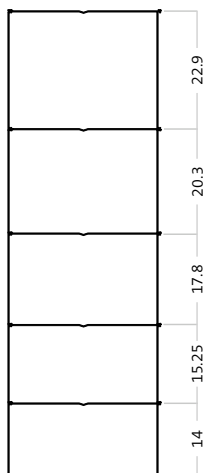

Coating
Heavy galvanised



Length
50/100 m

Vertical spacing
30 cm

Height
90 cm

C 6/90/30



HEAVY STOCK FENCING

MASTERFENCE® Heavy stock fencing is recommended for larger livestock.

HORIZONTAL WIRE			VERTICAL WIRE	
TOP AND BOTOM DIAMETER (mm)	INTERMEDIATE DIAMETER (mm)	TENSILE STRENGTH (kg/mm²)	DIAMETER (mm)	TENSILE STRENGTH (Kg/mm²)
4.00	3.00	≥71	3.00	45 - 55

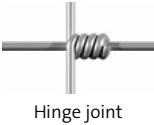
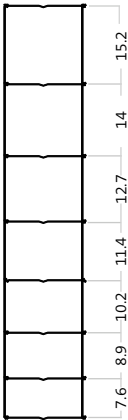
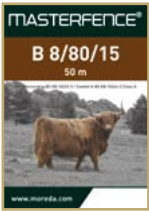

- Coating
Heavy galvanised
- Length
50 m
- Vertical spacing
15 cm
- Height
80 cm

B 8/80/15



LIGHT HIGH TENSILE STOCK FENCING

MASTERFENCE® Light High Tensile stock fencing is suitable for fencing farms, highways and railways.

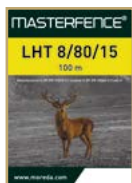

Hinge joint

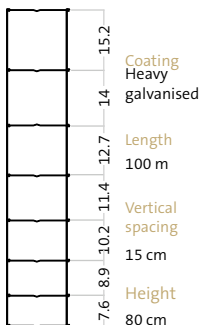

LHT 8/80/15

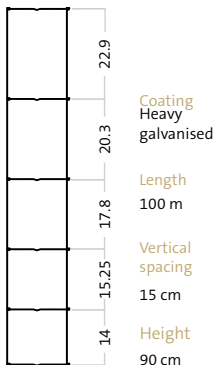

LHT 6/90/15

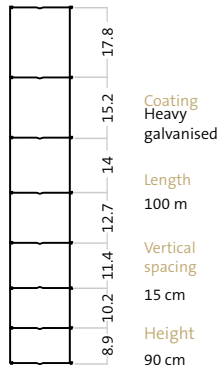

LHT 8/90/15



HIGH TENSILE STOCK FENCING



MASTERFENCE® High Tensile stock fencing is resistant to cattle impacts. The knot allows fencing to give under pressure and spring back into shape. HT series comes in centreless rolls for easier installation on fencing machines.

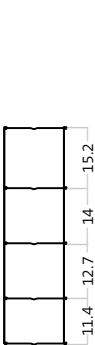

Hinge joint



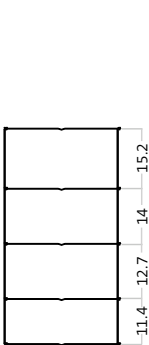

HT 5/53/15

Coating
2 

Length
100 m
Vertical
spacing
15 cm
Height
53 cm



HT 5/53/30

Coating
2 

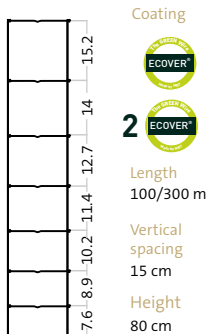
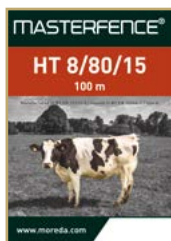
Length
100 m
Vertical
spacing
30 cm
Height
53 cm

HORIZONTAL WIRE			VERTICAL WIRE	
TOP AND BOTOM DIAMETER (mm)	INTERMEDIATE DIAMETER (mm)	TENSILE STRENGTH (kg/mm ²)	DIAMETER (mm)	TENSILE STRENGTH (Kg/mm ²)
2.45	2.45	≥120	2.45	≥61

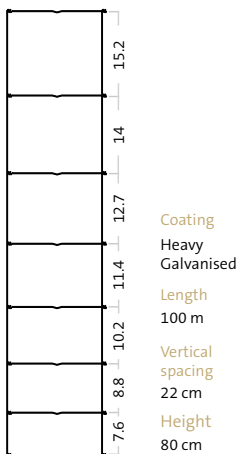

HT 8/80/15



HT 8/80/22

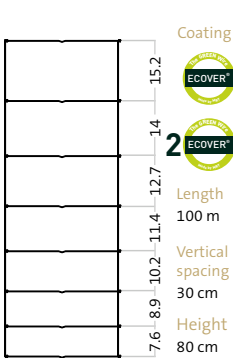

HT 8/80/30

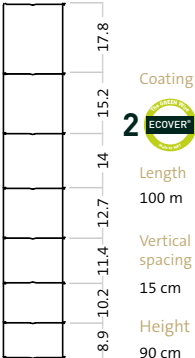

HT 8/90/15

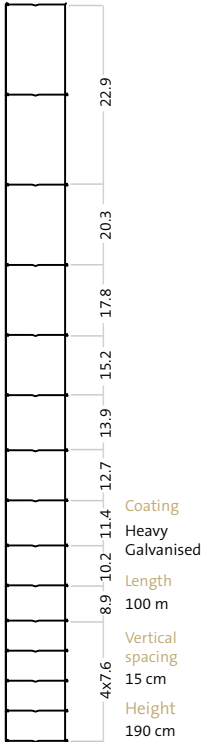

HT 15/190/15

We've got a knotted mesh for every need!



FK MRT® FIXED KNOT FENCE



FK MRT® provides the strength and durability needed for heavy animal containment. Up to four times stronger than standard high tensile fencing.



Fix knot

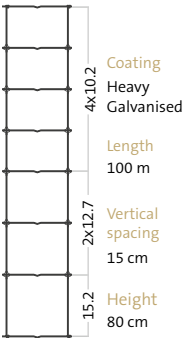

FK 8/80/15

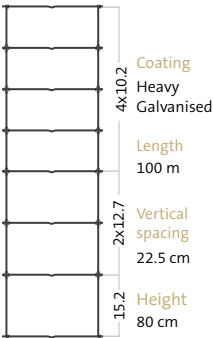

FK 8/80/22.5

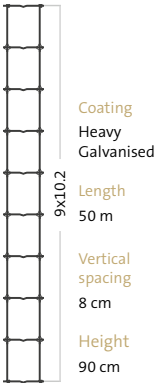

FK 10/90/8

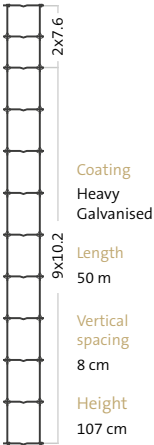

FK 12/107/8

HORIZONTAL WIRE		VERTICAL WIRE		KNOT WIRE	
DIAMETER (mm)	TENSILE STRENGTH (kg/mm ²)	DIAMETER (mm)	TENSILE STRENGTH (kg/mm ²)	DIAMETER (mm)	TENSILE STRENGTH (kg/mm ²)
2.50	123 - 142	2.50	≥71	2.24	41 - 54

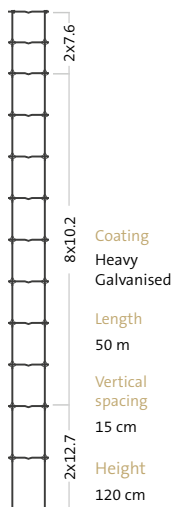

FK 13/120/8

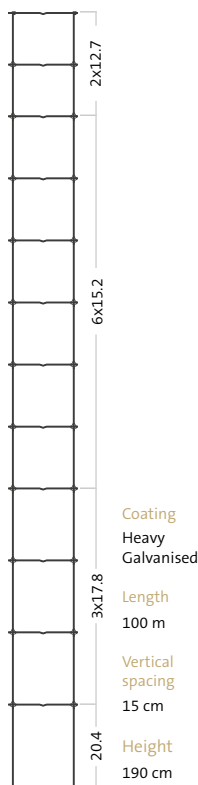

FK 13/190/15

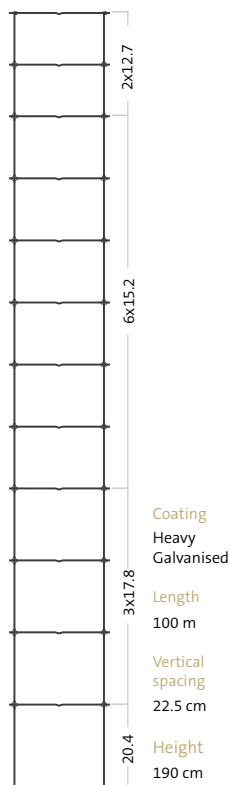

FK 13/190/22

XK MRT® STOCK FENCING



Made with high tensile wires for extra resistance to pressure and impact with minimal maintenance required. Continuous vertical wires grip the horizontals with a rigid knotted joint making installation easier with fewer posts.

Optional hinge joint can be added to help prevent burrowing or scaling.



X knot

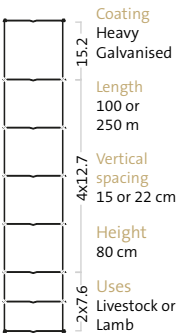

XK 8/80/ 15 22

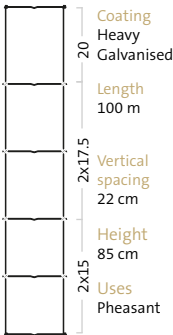

XK 6/85/ 22

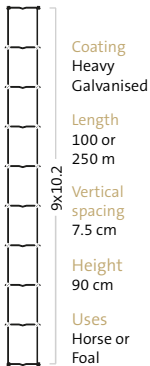

XK 10/90/7.5

HORIZONTAL WIRE		VERTICAL WIRE		KNOT WIRE	
DIAMETER (mm)	TENSILE STRENGTH (kg/mm ²)	DIAMETER (mm)	TENSILE STRENGTH (kg/mm ²)	DIAMETER (mm)	TENSILE STRENGTH (kg/mm ²)
2.50	123 - 142	2.50	≥71	2.50	45 - 55



Line wire with Hinge Joint

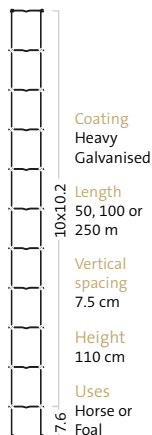

XK 12/110/7.5

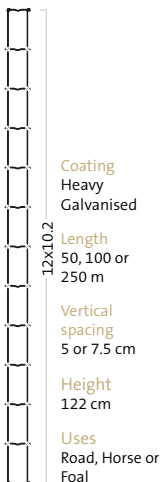

XK 13/122/ 5 7.5

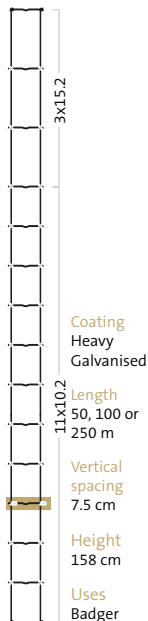

XK 15/158/7.5



Line wire with
Hinge Joint

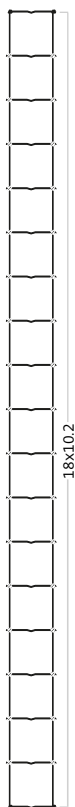

Coating
Heavy
Galvanised

Length
50, 100 or
250 m

Vertical
spacing
10 cm

Height
180 cm

Uses
Civil fence or
Embankment

XK 19/180/10

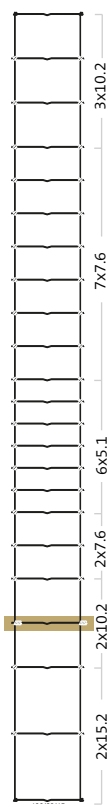

Coating
Heavy
Galvanised

Length
100 m

Vertical
spacing
15 cm

Height
180 cm

Uses
Badger / Boar

XK 23/180/15

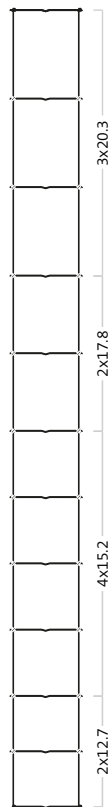

Coating
Heavy
Galvanised

Length
100 or
250 m

Vertical
spacing
15 cm

Height
182 cm

Uses
Deer

XK 12/182/15

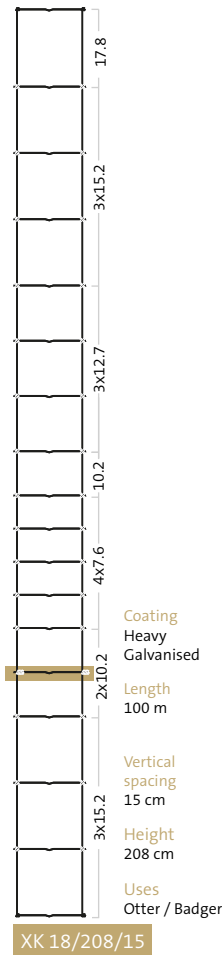
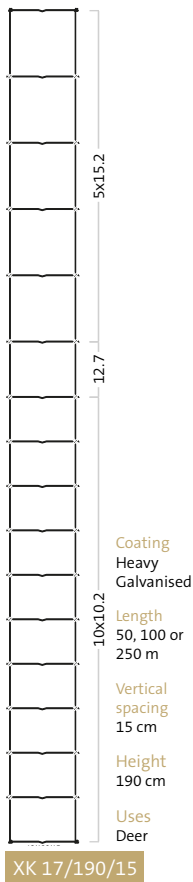
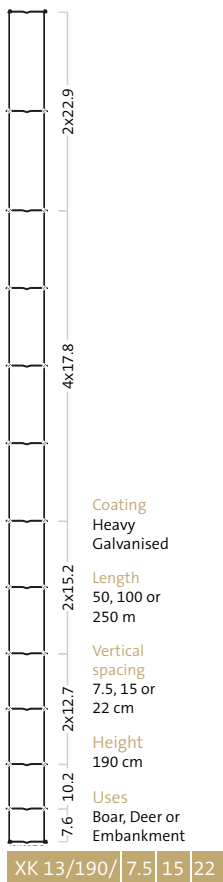



HIGH TENSILE BARBED WIRE

The ERIZO[®] is recommended for cattle and livestock.

- Meets BS EN10223-1

ROLL LENGTH (m)	200	
WIRE	Barb wire coiled into two twisted wires	
DIAMETER (mm)	1.60	2.00
FINISH	Heavy galvanised	 Heavy galvanised
DISTANCE BETWEEN BARBS (mm)	100	





MILD STEEL BARBED WIRE

The BRAVO® is recommended for crop protection.

- Meets BS EN10223-1

ROLL LENGTH (m)	200
WIRE	Fixed position interlocking barb
DIAMETER (mm)	2.50
FINISH	 Heavy galvanised
DISTANCE BETWEEN BARBS (mm)	80 - 150



BARBLESS WIRE



MRT barbless wire is a visible deterrent for horse enclosures with no danger of skin damage.

ROLL LENGTH (m)	200
DIAMETER (mm)	2.40
FINISH	Heavy galvanised





MRT Fence staples have plenty of holding power. The sharp point makes them easy to drive into wood and to be held securely in place.

- ♦ The hooks distance is wider enabling better securing of thicker wires.
- ♦ Extra holding power on wood posts.
- ♦ Easy to handle and install.
- ♦ U staple design does not scratch on wire coating.
- ♦ Available in 2 options:

Heavy galvanised or



LENGTH (mm)	DIAMETER (mm)	PLASTIC BUCKET (kg)
30	3.55 4.00	5
40		10 20



Double hook Barbed Staple



Barbless Staple



We have more than 150 years of experience in wire drawing and produce a wide range of steel wires in our own factories.

As wire drawers, we can manufacture an enormous variety of wires in many formats, diameters or compositions.

Composition

Our range of products include low and high carbon steel wires, both in soft and hard variations, you can choose the correct wire for every single use.

Diameters







We can make diameters from 0.90 mm to 8.26 mm. We have the perfect solution whether it is for a single coil for installing a vineyard or as a starting point to manufacture your own wire derivate products.

Coil format

Several coil formats and weights are available. Small coils from 5kg to 50kg and large ones from 400kg to 1,000kg, so you can use them or cut them according to your needs.

Coatings

We manufacture wire in six different coatings:

Commercial galvanised	
Heavy galvanised	
Super heavy galvanised	
Heavy galvanised + ECOVER®	
ZnAl® (Zinc + Aluminum)	
Galvanised & PVC coated by extrusion	

Feel free to ask any wire related inquiry, we can manufacture an enormous variety of wire and wire related products, we can help you to find the best solution for your needs.



SPECIAL COATINGS

In addition to standard coatings, MRT offers a range of special coatings with improved properties:

ZnAl

ZnAl® coating is a combination of 95% Zinc and 5% Aluminum that increases its durability. The aluminum oxide that builds up over time sticks better to the surface than zinc oxide, reducing the covering mass loss.

Tests show it can resist up to 1,000 hours in a salt spray chamber before red rusting starts.



The Ecover® is a covering applied to Class III galvanized wire, made of a passivated metallic coating, based in Titanium (Ti) and Chromium (Cr³⁺), adds an excellent resistance against corrosion and a better integration with nature thanks to its color. The product used to make

the Ecover® enhances low friction properties of the wire coefficient, improving its transformation into netting. This treatment does not use any Hexavalent Chromium during the process.

Beginning of red rusting in salt spray chamber



Choose
your option



IT'S
GREEN

ALL or 2
WIRES WIRES



MRT wire netting is recommended for use in small animal enclosures, cage construction. This type of netting provides predator-proof protection for domestic fowd, gardens and agricultural purposes. It is galvanised after weaving for extra life expectancy.

THICKNESS	18g (1.20mm.) / 19g (1.00mm.)
MESH (mm)	31
HEIGHT (m)	1,050 / 1,200
ROLL (m)	50
FINISH	Post Coated



CHAIN LINK FENCE



MRT chain link fence, with its diamond shape is an economical solution for all fins of applications.

- ◆ Knuckled and barbed ends are available.
- ◆ Compacted rolls with unrolling wires and paper protection
- ◆ Flexibility when installing
- ◆ 12.5 m and 25 m long rolls.
- ◆ Heavy galvanised, PVC coated, ECOVER® green and ZnAl® coatings available.
- ◆ Meets or exceeds BS EN 1722-1

Knuckled end



Barbed end



WIRE DIAMETER (mm)	HEIGHT (cm)	MESH SIZE (mm)	LENGHT (cm)	FINISH	LINE WIRE INCLUDED
2.50	90	50	25	Heavy galvanised	✓
2.50	120	50	25	Heavy galvanised	✓
2.50	180	50	25	Heavy galvanised	✓
2.50	240	50	12.5	Heavy galvanised	✓
3.00	90	50	25	Heavy galvanised	✓
3.00	120	50	25	Heavy galvanised	✓
3.00	180	50	25	Heavy galvanised	✓
3.00	150	50	12.5	Heavy galvanised	✓
3.00	240	50	12.5	Heavy galvanised	✓
3.00	140	40	12.5	Heavy galvanised	
3.00	180	40	12.5	<u>High Tensile</u> 	
2.24 / 3.15	90	50	25	PVC Coated	✓
3.15 / 2.24	120	50	25	PVC Coated	✓
3.15 / 2.24	180	50	25	PVC Coated	✓
3.15 / 2.24	240	50	12.5	PVC Coated	✓
3.15 / 2.24	300	50	12.5	PVC Coated	
3.55 / 2.40	180	50	12.5	PVC Coated	
3.55 / 2.40	210	50	12.5	PVC Coated	
3.55 / 2.40	240	50	12.5	PVC Coated	
3.55 / 2.40	305	50	12.5	PVC Coated	
3.90 / 2.70	180	50	12.5	PVC Coated	
3.90 / 2.70	300	50	12.5	PVC Coated	
4.40 / 3.00	100	50	25	PVC Coated	
4.40 / 3.00	300	50	12.5	PVC Coated	

WELDED MESH IN ROLLS



MRT welded mesh is a great multipurpose solution for all manner of industrial and agricultural applications.

MESH (mm)	6x6 / 8x8 / 10x10 / 13x13 / 16x16 / 19x19 / 25x13 / 25x25 / 51x25 / 51x51 / 102x51
WIRE (mm)	from 0.80 to 3.00
HEIGHT (mm)	from 508 to 2,032
ROLL (m)	5 - 25 - 30
FINISH	Heavy galvanised / PVC Coated / Post-galvanised

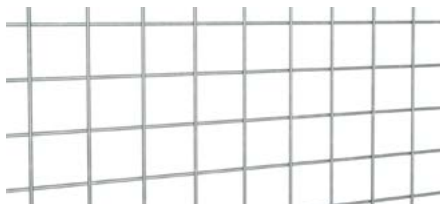

MORE PRODUCTS

At the MRT we have a wide range of fencing products such as panels, posts, railings, gates, meshes and a complete range of accessories to compliment your fencing. In order to offer you the best solution for your farm, ranch, industry, home or garden, we control the total production process.



We provide the best powder coating treatment available, microcrystalline phosphatation. This enables us to guarantee the highest quality perimeter protection and security fencing products.

The MRT warranty is proof of the highest quality, certifying the resistance to corrosion of our range of powder coat panel fences. ECOVER® green products can get up to 25 years of warranty.



YOUR CONTACT

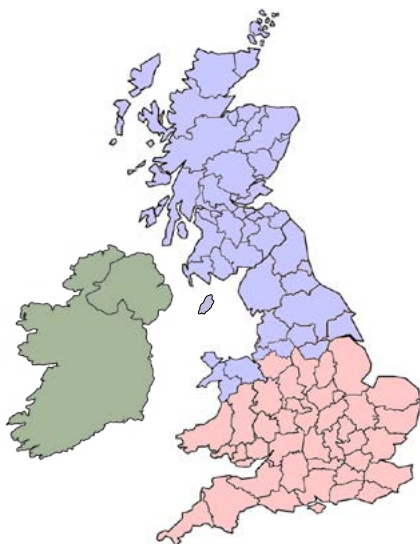

Northern Europe Area Manager:

SAM MIRAB

+34 608 169 793

sam@moreda.com

Sales Manager North:

TONY EAST

07795 011 827

tonyeast@moreda.com

Sales Manager South:

ANDY QUINN

07483 017 353

andyquinn@moreda.com



MRT Fencing

Bullhouse Works, Manchester Road
Penistone
S36 9FG

mrtfencing@moreda.com

01623 703 991

BARCELONA

C/ Montclar, 61. Polígono Polizur
08290 Cerdanyola del Vallès
Barcelona - SPAIN

Can we help you?

+34 935 944 400

salestm@moreda.com

GIJÓN

Av. Príncipe de Asturias, s/n
33211 Gijón
Asturias - SPAIN
Phone: +34 985 308 060



moreda.com

CELSA | **MRT**
MORDA RIVERA
TRANSPORTES